



Know what's below.
Call before you dig.

sunshine state



CIVIL CONSTRUCTION DRAWINGS FOR:

QUINCY CDBG

PREPARED FOR:

CITY OF QUINCY
GADSDEN COUNTY, FLORIDA

BID SET



ARCHITECTURAL, PLUMBING AND STRUCTURAL PLANS UNDER SEPARATE COVER



This Item has been digitally signed and sealed by David P. Reisen, P.E. Printed Copies of this document are not considered signed and sealed and the signature must be verified on any electronic copies.
2026.03.30 09:42:52-05'00'

AS TO SHEETS CVR, G1, KEY, C1-C8, D1-D5

OWNER, ENGINEER, SURVEYOR, ARCHITECT

OWNER: CITY OF QUINCY
404 WEST JEFFERSON STREET
QUINCY, FLORIDA 32351
850-618-0020

ENGINEER: DEWBERRY ENGINEERS INC.
20684 CENTRAL AVENUE EAST
BLOUNTSTOWN, FLORIDA 32424
850-674-3300

SURVEYOR: DEWBERRY ENGINEERS INC.
203 ABERDEEN PARKWAY
PANAMA CITY, FL 32405
850-522-06449

ARCHITECT: JOEL SAMPSON
212 NORTH ADAMS STREET
QUINCY, FL 32351
850-875-4348

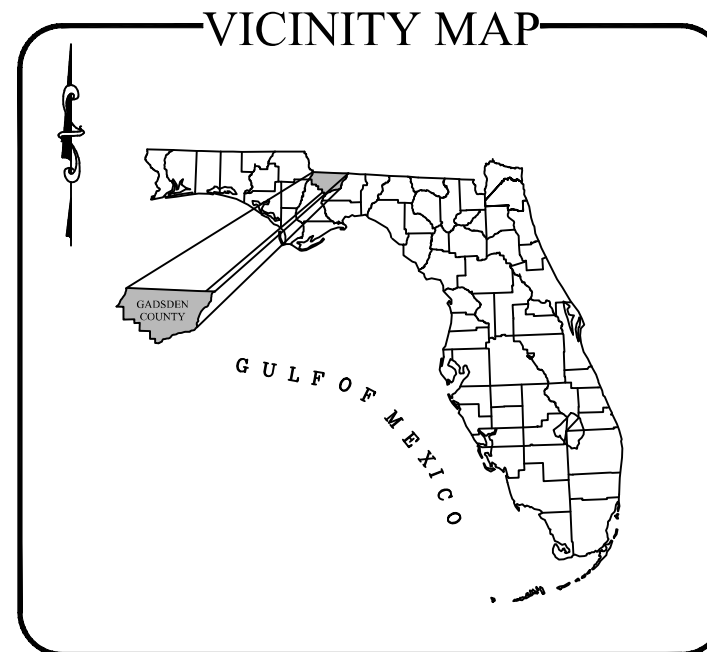

DRAWING INDEX	
<u>NO.</u>	<u>TITLE</u>
CVR	COVER SHEET
G1	GENERAL NOTES
KEY	KEY SHEET
S1-S4	TOPOGRAPHIC SURVEY
C1	ANDY GAY PARK SITE PLAN
C2-C3	WASHINGTON STREET PLAN VIEW
C4-C5	ADAMS STREET PLAN VIEW
C6	MADISON STREET PLAN VIEW
C7-C8	JEFFERSON STREET PLAN VIEW
D1-D5	PROJECT DETAILS

PREPARED BY:



APRIL 2026

ERRORS AND OMISSIONS, IF ANY, IN THESE CONSTRUCTION DOCUMENTS SHALL IMMEDIATELY BE BROUGHT TO THE ATTENTION OF THE ENGINEER FOR RESOLUTION.

GENERAL CONTRACTOR TO THOROUGHLY INSPECT EXISTING CONDITIONS PRIOR TO SUBMITTING BIDS. ANY DISCREPANCIES BETWEEN PLANS AND FIELD CONDITIONS SHALL BE NOTED AT ONCE AND CALLED TO THE ENGINEER'S ATTENTION 48 HOURS PRIOR TO SUBMITTING BIDS.

ALL CORRESPONDENCE IN REGARDS TO THESE CONSTRUCTION/BID DOCUMENTS SHALL BE DIRECTED TO DEWBERRY ENGINEERS 20684 CENTRAL AVE E. BLOUNTSTOWN FL. 32424

GOVERNING STANDARDS AND SPECIFICATIONS: FLORIDA DEPARTMENT OF TRANSPORTATION, STANDARD PLANS FOR ROAD AND BRIDGE CONSTRUCTION DATED: LATEST EDITION, AS AMENDED BY CONTRACT DOCUMENTS.

BID SET

SCALE
NO SCALE

Table with 3 columns: NO., DESCRIPTION, DATE. Revisions section.

Table with 3 columns: NO., DESCRIPTION, DATE. Drawing information section.

TITLE

GENERAL NOTES

PROJECT NO. 50158855

G1

SHEET NO.

GENERAL NOTES:

- 1. THE EXACT LOCATION AND ELEVATION OF EXISTING STRUCTURES, UTILITIES, AND PIPING SHALL BE PHYSICALLY VERIFIED IN THE FIELD BY THE CONTRACTOR BEFORE CONSTRUCTION BEGINS...
2. THE CONTRACTOR SHALL CHECK PLANS FOR CONFLICTS AND DISCREPANCIES PRIOR TO CONSTRUCTION...
3. THE CONTRACTOR SHALL EXERCISE EXTREME CAUTION IN AREAS OF BURIED UTILITIES AND SHALL PROVIDE AT LEAST 48 HOURS NOTICE TO THE VARIOUS UTILITY COMPANIES...
4. THE CONTRACTOR IS RESPONSIBLE FOR REPAIRING ANY DAMAGE TO EXISTING FACILITIES ABOVE OR BELOW GROUND THAT MAY OCCUR AS A RESULT OF WORK CALLED FOR IN THESE CONTRACT DOCUMENTS...
5. IT SHALL BE THE RESPONSIBILITY OF THE CONTRACTOR TO LEARN, KNOW, AND COMPLY WITH THE REGULATIONS, ORDINANCES, PERMIT AND INSPECTION REQUIREMENTS OF THE VARIOUS GOVERNMENTAL AGENCIES...
6. ALL SPECIFICATIONS AND DOCUMENTS REFERRED TO SHALL BE OF LATEST ISSUE AND SHALL BE CONSIDERED A PART OF THESE DOCUMENTS AS THOUGH INCLUDED...
7. IT SHALL BE THE CONTRACTOR'S SOLE RESPONSIBILITY TO MAINTAIN ADEQUATE TRAFFIC CONTROL AND TO PROVIDE DETOURS AROUND CONSTRUCTION ACTIVITIES...
8. PRIOR TO COMMENCING CONSTRUCTION, CONTRACTOR SHALL INSTALL ANY REQUIRED SILT FENCING OR BALED HAY BARRIERS...
9. THE CONTRACTOR SHALL INSTALL ALL TRAFFIC CONTROL DEVICES REQUIRED FOR THE PROJECT IN ACCORDANCE WITH THE LATEST EDITION OF THE U.S. DEPARTMENT OF TRANSPORTATION FEDERAL HIGHWAY ADMINISTRATION MANUAL...
10. WHERE IT BECOMES NECESSARY TO TEMPORARILY REMOVE, REPOSITION, OR SUPPORT EXISTING FACILITIES, UTILITY POLES, ETC., THIS WORK SHALL BE PERFORMED AT THE CONTRACTOR'S EXPENSE...
11. WORK ALONG STREETS MAY REQUIRE THE REMOVAL AND REPLACEMENT OF EXISTING DRAINAGE PIPE, STRUCTURES, HEADWALLS, ETC., THE COST OF THIS WORK SHALL BE INCLUDED IN THE UNIT PRICE BID FOR RELATED ITEMS OF WORK...
12. COPIES OF TEST REPORTS FOR ASPHALT, SUBGRADE, FILL, AND BACKFILL UNDER ROADWAYS AND STRUCTURES, AND UTILITY TRENCHES SHALL BE PROVIDED DIRECTLY TO THE ENGINEER FOR APPROVAL...
13. ANY DISTURBED SIGNS MUST BE REINSTALLED TO EXISTING OR ACCEPTABLE CONDITION BY THE OWNER AT THE CONTRACTOR'S EXPENSE...
14. CONTRACTOR SHALL HAVE COPIES OF ALL PERMITS (CITY, COUNTY, FOOT & FDEP) IN POSSESSION AT ALL TIMES DURING CONSTRUCTION...
15. TESTING REQUIREMENTS SHALL BE IN ACCORDANCE WITH THE TESTING SCHEDULE CONTAINED WITHIN THESE PLANS...
16. IT SHALL BE RESPONSIBILITY OF THE CONTRACTOR TO COORDINATE AND SCHEDULE THE ACTIVITIES OF THE UTILITY COMPANIES INCLUDING BUT NOT LIMITED TO TV, TELEPHONE, GAS, POWER, ETC...
17. ALL CONSTRUCTION STAKING SHALL BE DONE AT CONTRACTOR'S EXPENSE...
18. STATIONING ON THE PLANS RELATES TO THE CENTERLINE OF ALL ROADWAYS/ RIGHT-OF-WAYS AND SHALL BE USED FOR LOCATION PURPOSES ONLY...
19. THE CONTRACTOR SHALL TAKE WHATEVER PRECAUTIONS NECESSARY TO AVOID TRESPASSING AND DAMAGING PRIVATE PROPERTY...
20. ALL SPOIL MATERIAL FROM EXCAVATION SHALL BE PLACED ON THE UPLAND SIDE OF ANY SLOPED CONSTRUCTION AREA...
21. THE CONTRACTOR SHALL TAKE WHATEVER STEPS NECESSARY TO PREVENT EROSION INTO NEARBY WETLANDS WHICH INCLUDES TURBIDITY CURTAINS, HAY BALES, AND ALL OTHER METHODS TO CONTROL EROSION AT NO ADDITIONAL COST TO OWNER...
22. THE CONTRACTOR SHALL MAINTAIN A REASONABLE ACCESS TO ALL RESIDENCES AND BUSINESSES DURING CONSTRUCTION...
23. ALL EXISTING CONCRETE, ASPHALT, TREES, STUMPS, AND OTHER DELETERIOUS MATERIAL WITHIN LIMITS OF CONSTRUCTION SHALL BE REMOVED FROM THE SITE AND DISPOSED OF IN ACCORDANCE WITH FLORIDA LAWS...
24. DEWATERING, SHOULD LOWERING OF GROUNDWATER BE NECESSARY FOR THE INSTALLATION OF CONCRETE STRUCTURES, GRAVITY SEWER, FORCE MAINS, WATER MAINS, ETC., OR TO PREVENT LATERAL MOVEMENT OF MATERIAL UNDER CONCRETE ALREADY PLACED...
25. CONTRACTOR SHALL FURNISH "AS BUILT PLANS" INDICATING LOCATIONS OF ALL FEATURES, PIPES, PONDS, PADS, MANHOLES, FITTINGS, VALVES, AND DEAD END RUNS WITH THREE (3) PHYSICAL FEATURES (LOT CORNERS, TREES, ETC.)...
26. THE CONTRACTOR SHALL REMOVE AND REPLACE, TO THEIR ORIGINAL NATURE, ALL DISTURBED MATERIALS OR OBJECTS WITHIN THE PATH OF THE NEW UTILITIES AS NECESSARY...
27. CONTRACTOR SHALL FOLLOW ALL LOCAL, STATE, AND FEDERAL REQUIREMENTS FOR CONSTRUCTION...
28. A TWO AND ONE HALF FOOT STRIP OF SOO SHALL BE INSTALLED ON THE EDGE OF ALL ASPHALT AND ASPHALT MILLING AREAS AND AROUND ALL ABOVE GROUND CONCRETE STRUCTURES INCLUDING BUT NOT LIMITED TO VALVE PADS, BLOW OFF VAULTS, AND AIR RELEASE VAULTS...
29. PROPOSED SPOT ELEVATIONS REPRESENT PAVEMENT OR GROUND SURFACE GRADE UNLESS OTHERWISE NOTED ON DRAWINGS...
30. CONTRACTOR SHALL BE RESPONSIBLE FOR THE COST OF COORDINATION WITH ELECTRIC COMPANY TO STABILIZE POWER POLES AS THEY ARE ENCOUNTERED THROUGHOUT THE ENTIRE PROJECT...
31. REMOVAL AND REPLACEMENT OF EXISTING DRIVEWAYS AND DRIVEWAY CULVERTS SHALL BE INCLUDED IN THE BID PRICE...
32. REMOVAL AND REPLACEMENT OF EXISTING SIGNS, MAILBOXES, SODDING, IRRIGATION, LANDSCAPING, STRUCTURES, ETC. SHALL BE INCLUDED IN THE BID PRICE...
33. COMPACTION TESTING SHALL BE PERFORMED AT THE ROADWAY CUT FOR EXCAVATION AND BACKFILL SHALL BE COMPACTED PER FOOT SPECIFICATIONS FOR ROAD RECONSTRUCTION AND SHALL BE INCLUDED IN THE BID PRICE...
34. THE LOCATIONS OF UTILITIES SHOWN ARE APPROXIMATE. THE CONTRACTOR SHALL FIELD VERIFY THE LOCATION OF ALL EXISTING UTILITIES PRIOR TO CONSTRUCTION...
35. CONTRACTOR SHALL PROVIDE THE ENGINEER WITH A MAINTENANCE OF TRAFFIC PLAN PRIOR TO COMMENCEMENT OF CONSTRUCTION...
36. CONTRACTOR SHALL BE RESPONSIBLE FOR OBTAINING THE NPOES PERMIT AND MAINTAINING THE SILT FENCE, INLET PROTECTION, AND ANY OTHER EROSION CONTROL NECESSARY IN THE NPOES PERMIT GUIDELINES.

TRAFFIC CONTROL GENERAL NOTES

- 1. EXISTING POSTED SPEED LIMITS SHALL BE MAINTAINED FOR ALL WORK...
2. THE FOLLOWING LANE CLOSURE RESTRICTIONS SHALL BE REQUIRED MONDAY THROUGH SUNDAY: NO LANE CLOSURES ON JEFFERSON, ADAMS AND MADISON STREETS...
3. TRAVEL LANE WIDTHS WITHIN THE PROJECT LIMITS SHALL BE MAINTAINED IN ACCORDANCE WITH INDEX 102-600, SHEET 3...
4. UTILIZE FOOT STANDARD PLANS INDEX 102-660 TO MAINTAIN EXISTING PEDESTRIAN PATHWAY CONVEYANCE THROUGHOUT THE PROJECT LIMITS WHILE RECONSTRUCTING SIDEWALKS AND DRIVEWAYS...
5. UTILIZE FOOT STANDARD PLANS INDEX 102-662 TO PERFORM MISCELLANEOUS ACTIVITIES...
6. ALL LANES MUST BE REOPENED TO NORMAL TRAFFIC WITHIN 12 HOURS OF AN EVACUATION NOTICE FOR A HURRICANE OR ANY OTHER EMERGENCY EVENT AND SHALL REMAIN OPEN FOR THE DURATION OF THE EVENT AS DIRECTED BY THE ENGINEER.

PROJECT NOTES:

NOTE TO CONTRACTOR:

- 1. EVERY EFFORT HAS BEEN MADE TO ENSURE THAT THE BUILDING INDICATED IN THESE DRAWINGS MATCHES THE ARCHITECTS LATEST BUILDING AND FOUNDATION PLAN...
2. THE CONTRACTOR SHALL MAINTAIN ACCESS TO THE SITE FOR THE DURATION OF THE PROJECT...
3. ALL EARTHWORK SHALL BE PERFORMED IN STRICT COMPLIANCE WITH GEOTECHNICAL RECOMMENDATIONS AND SHALL COMPLY WITH GEOTECH PROVIDED BY MAGNUM ENGINEERING DATED DECEMBER 3, 2024...
4. ALL CONDUIT LOCATIONS FOR POWER, TELEPHONE, AND CABLE SHALL BE COORDINATED WITH ARCHITECTURAL PLANS AND LOCAL UTILITY PROVIDERS...
5. CONTRACTOR SHALL PERFORM PRESSURE TESTING AND BACTERIAL TESTING ON ALL WATER LINES...
GENERAL NOTES
1. ALL NEW WORK SHOWN IN THESE PLANS SHALL COMPLY WITH APPLICABLE STATE, FEDERAL AND LOCAL BUILDING AND UTILITY INSTALLATION CODES...
2. NO WORK SHALL COMMENCE, INCLUDING DEMOLITION, UNTIL ALL APPLICABLE EROSION CONTROL MEASURES HAVE BEEN INSTALLED, INSPECTED AND APPROVED...
3. EROSION CONTROL DEVICES ARE TO BE INSTALLED PRIOR TO ANY CLEARING OR EARTHWORK OPERATIONS AND SHALL BE MAINTAINED THROUGHOUT CONSTRUCTION AND UNTIL PERMANENT GROUND COVER IS ESTABLISHED IN ALL DISTURBED AREAS...
4. ALL DEMOLITION TO BE DISPOSED OF IN ACCORDANCE WITH ALL LOCAL, STATE, AND FEDERAL LAWS AND REGULATIONS...
5. CONTRACTOR TO HAVE ALL UTILITIES LOCATED PRIOR TO CONSTRUCTION...
6. SEE CONSTRUCTION NOTES SHEET FOR OTHER APPLICABLE PROTECT SPECIFIC NOTES.

EXISTING UTILITIES DISCLAIMER:

THESE PLANS ARE BASED ON AVAILABLE INFORMATION. CONTRACTOR IS REQUIRED TO VERIFY LOCATION, BURY DEPTH, SIZE AND MATERIAL TYPE PRIOR TO ANY UTILITY IMPROVEMENTS. THE ENGINEER SHALL BE NOTIFIED IMMEDIATELY OF ANY DISCREPANCIES THAT ARE FOUND.

UTILITY NOTES

- 1. CONTRACTOR TO COORDINATE WITH UTILITY PROVIDERS ON UTILITY RELOCATIONS AND ADJUSTMENTS...
2. CONTRACTOR SHALL ADJUST ALL UTILITIES INCLUDING BUT NOT LIMITED TO VALVES, MANHOLES, VAULTS, HYDRANTS, COMMUNICATION POST/BOXES, METERS, ETC...
3. CONTRACTOR RESPONSIBLE TO REROUTE AND/OR DEFLECT UTILITIES AS NEEDED TO CONSTRUCT PROPOSED IMPROVEMENTS...
4. CONTRACTOR SHALL NOTIFY CIVIL ENGINEER IF ANY UTILITIES CONFLICT WITH PROPOSED IMPROVEMENTS.

AS BUILT/RECORDED DRAWINGS

- 1. CONTRACTOR SHALL PROVIDE ENGINEER OF RECORD TWO SIGNED AND SEALED COPIES OF AS-BUILT DRAWINGS OF ALL FINISHED IMPROVEMENTS...
2. AS-BUILT DRAWINGS TO BE PERFORMED AND CERTIFIED BY A FLORIDA LICENSED PROFESSIONAL LAND SURVEYOR...
3. AS-BUILT DRAWINGS SHALL BE SUBMITTED AFTER COMPLETION OF ALL IMPROVEMENTS AND PRIOR TO FINAL INSPECTION...
4. AS BUILT DRAWINGS SHALL INCLUDE, BUT NOT BE LIMITED TO:

D.SHOW ALL TRAFFIC CONTROL DEVICES INCLUDING SIGNS, SIGNALS, PARKING STRIPPING AND PAVEMENT MARKINGS.

- A. ANY ADDITIONAL ITEMS REQUIRED BY PERMITTING JURISDICTION.

ADA COMPLIANCE NOTES:

THE CONTRACTOR & OWNER WILL BE HELD ACCOUNTABLE DURING CONSTRUCTION FOR ALL SITE IMPROVEMENTS. COMPLIANCE WITH FLORIDA STATUTES 553.5041 (F.S.) AND THE 2020 FLORIDA BUILDING CODE: ACCESSIBILITY, 7TH EDITION (FBC-A), IS MANDATORY. IF NON-COMPLIANT AT FINAL INSPECTION, CONTRACTOR WILL BE REQUIRED TO MODIFY CONSTRUCTION TO COMPLY WITH F.S. AND FBC-A.

- 5. ACCESSIBLE PARKING SPACES AND ACCESS AISLES SERVING A PARTICULAR BUILDING SHALL BE LOCATED ON THE SHORTEST ACCESSIBLE ROUTE FROM THE ACCESSIBLE (H/C) PARKING TO AN ACCESSIBLE ENTRANCE...
6. ACCESSIBLE PARKING SPACES SHALL BE 12' WIDE, AND OUTLINED WITH BLUE PAINT...
7. ACCESS AISLES REQUIRED ADJACENT TO PARKING SPACES SHALL BE 5' WIDE WITH DIAGONAL STRIPING...
8. ACCESSIBLE PARKING AND ACCESS AISLES SHALL BE LEVEL (NOT TO EXCEED 1/48) ON A STABLE FIRM & SLIP RESISTANT SURFACE...
9. ACCESSIBLE PARKING SIGNS SHALL BE FOOT APPROVED AND SHALL READ "PARKING BY DISABLED PERMIT ONLY" AND SHALL INDICATE A \$250 FINE FOR ILLEGAL USE...
10. CURB RAMPS SHALL NOT EXCEED 1:12 SLOPE...
11. CURB RAMPS SHALL HAVE A LANDING WITH A MINIMUM CLEAR LENGTH OF 36" SHALL BE LOCATED AT THE TOP SIDE OF EACH CURB RAMP...
12. ALL RAMPS WITH A RISE GREATER THAN 6" SHALL PROVIDE EDGE PROTECTION...
13. ALL RAMPS WITH A RISE GREATER THAN 6" SHALL PROVIDE EDGE PROTECTION...
14. ACCESSIBLE ROUTES TO "MAIN ENTRY" FROM AN ACCESSIBLE PARKING SPACE...
15. *CONNECT BUILDINGS WITHIN THE SAME SITE WITH AN ACCESSIBLE ROUTE WHICH SHALL NOT EXCEED 1:20 SLOPE...

TESTING SCHEDULE

Table with 5 columns: ITEM, TEST, TEST IDENTIFICATION, TEST REQUIREMENT, TEST FREQUENCY. Includes rows for UTILITY TRENCH, FILL & BACKFILL, GRADATION, FILL & BACKFILL UNDER ROADWAYS, LIMEROCK BASE, BEARING VALUES, MAXIMUM DENSITY, OPTIMUM MOISTURE, FIELD DENSITY.

STORM WATER POLLUTION PREVENTION PLAN:

- 1. SITE DESCRIPTION: CONSTRUCTION ACTIVITY: SIDEWALK CONSTRUCTION, LANDSCAPING, UTILITIES, EROSION CONTROL...
PROJECT LIMITS: SEE SHEETS C1-C8
PROJECT DESCRIPTION: SIDEWALK CONSTRUCTION, LANDSCAPING, UTILITIES, EROSION CONTROL
MAJOR SOIL DISTURBING ACTIVITIES: EROSION CONTROL & SIDEWALK RECONSTRUCTION
A. TOTAL PROJECT AREA: 1+ ACRE
B. TOTAL SOIL AREA TO BE DISTURBED: >1 ACRE
C. FOR LOCATIONS OF DRAINAGE AREAS AND OUTFALLS: N/A
a. NAME OF RECEIVING WATERS: NO DISTURBANCE TO NON-ISOLATED WETLANDS ARE ANTICIPATED.
b. WETLAND AREA: NO DISTURBANCE TO NON-ISOLATED WETLANDS ARE ANTICIPATED.
2. CONTROLS: NARRATIVE - SEQUENCE OF SOIL DISTURBING ACTIVITIES AND IMPLEMENTATION OF CONTROLS.
A. THE SOIL DISTURBING ACTIVITIES FOR THIS PROJECT ARE AS FOLLOWS: ONLY UPON PROPER PLACEMENT OF ALL EROSION CONTROLS CAN SOIL DISTURBING ACTIVITIES TAKE PLACE...
B. EROSION AND SEDIMENT CONTROLS:
a. STABILIZATION PRACTICES:
X TEMPORARY SODDING
X TEMPORARY GRASSING
X PERMANENT PLANTING, SODDING, OR SEEDING
TEMPORARY MULCHING
ARTIFICIAL COVERING
b. STRUCTURAL PRACTICES:
SAND BAGGING
X SILT FENCES
X HAY BALES
X BERMS
DIVERSION, INTERCEPTOR, OR PERIMETER DITCHES
PIPE SLOPE DRAINS
FLUMES
ROCK BEDDING AT CONSTRUCTION EXIT
TIMBER BEDDING AT CONSTRUCTION EXIT
DITCH LINER
c. SANITARY WASTE: N/A
d. FERTILIZERS AND PESTICIDES: FERTILIZERS AND/OR PESTICIDES SHALL BE APPLIED ACCORDING TO MANUFACTURERS RECOMMENDATIONS...
e. NON-STORMWATER DISCHARGE (INCLUDING SPILL REPORTING): NO NON-STORMWATER DISCHARGES ARE ANTICIPATED.
C. DESCRIPTION OF STORM WATER MANAGEMENT: NA
D. OTHER CONTROLS:
a. WASTE DISPOSAL: NO CONSTRUCTION WASTE MATERIAL WILL BE BURIED ON SITE.
b. OFFSITE VEHICLE TRACKING:
HAUL ROADS DAMPENED FOR DUST CONTROL
X LOADED HAUL TRUCKS TO BE COVERED WITH TARPULIN
X EXCESS DIRT ON ROAD REMOVED DAILY
X STABILIZE CONSTRUCTION ENTRANCE
c. SANITARY WASTE: N/A
d. FERTILIZERS AND PESTICIDES: FERTILIZERS AND/OR PESTICIDES SHALL BE APPLIED ACCORDING TO MANUFACTURERS RECOMMENDATIONS...
e. NON-STORMWATER DISCHARGE (INCLUDING SPILL REPORTING): NO NON-STORMWATER DISCHARGES ARE ANTICIPATED.
E. APPROVED STATE, LOCAL PLANS
3. MAINTENANCE: ALL OF THE CONTROLS SHALL BE MAINTAINED AT ALL TIMES...
4. INSPECTION:
A. ALL CONTROLS SHALL BE INSPECTED WEEKLY...
B. THE CONTRACTOR SHALL INITIATE REPAIRS WITHIN 24 HOURS...
C. IF INSPECTIONS INDICATE THAT THE INSTALLED STABILIZATION AND STRUCTURAL PRACTICES ARE NOT SUFFICIENT...
D. RECORDS OF THE INSPECTION AND THE CONSTRUCTION PERMIT MUST BE MAINTAINED AT THE CONSTRUCTION SITE...
1. THE CONTRACTOR IS RESPONSIBLE FOR OBTAINING COVERAGE UNDER THE GENERAL PERMIT FOR STORMWATER DISCHARGE...
2. THE CONTRACTOR IS RESPONSIBLE FOR FOLLOWING REQUIRED WASTE MANAGEMENT PRACTICES AS DEFINED IN THE GADSDEN COUNTY MUNICIPAL CODE...
3. SWEEPING SHALL OCCUR DAILY OR IMMEDIATELY AFTER SUCH EVENTS THAT CAUSE TRACKING ONTO STREET.

QUINCY FLORIDA
CDBG HR IMPROVEMENTS
QUINCY FLORIDA

SEAL

DAVID P. REISEN P.E. #60229
EB 0008794

BID SET

SCALE

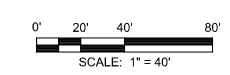

REVISIONS

NO.	DESCRIPTION	DATE

DRAWN BY DPR
APPROVED BY _____
CHECKED BY DPR
DATE APRIL 2026

TITLE

KEY SHEET

PROJECT NO. 50162593

KEY

SHEET NO.

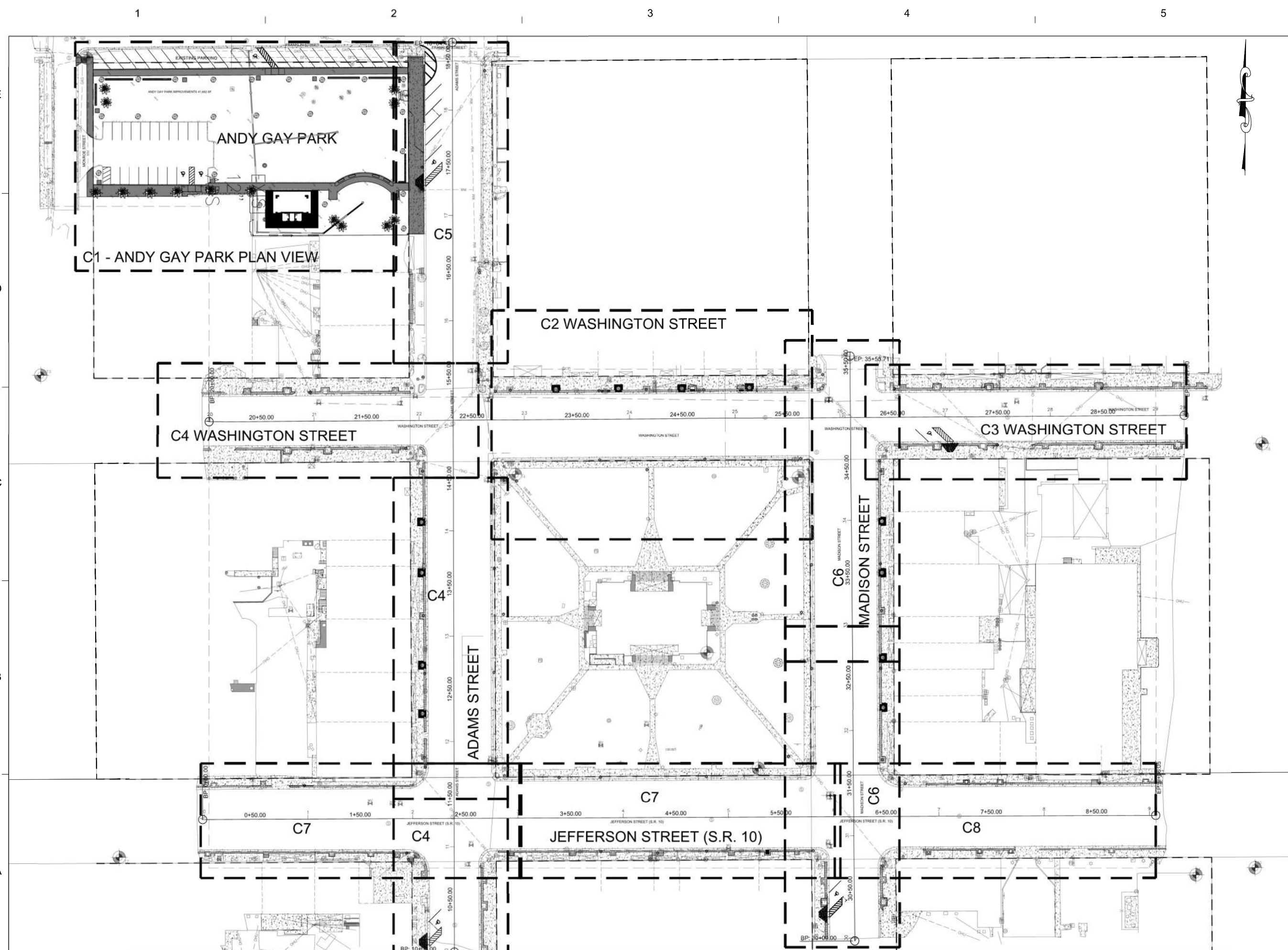

ANDY GAY PARK

C1 - ANDY GAY PARK PLAN VIEW

C2 WASHINGTON STREET

C4 WASHINGTON STREET

C3 WASHINGTON STREET

ADAMS STREET

MADISON STREET

JEFFERSON STREET (S.R. 10)

C7

C4

C7

C6

C8

1

2

3

4

5

E

D

C

B

A

Z:\PROJECTS\QUINCY\ENGINEERING\PRODUCTION\QUINCY_CDBG_HR_REDUCED_SCOPE_2.2026.DWG

August 7, 2023 (15:18:33 EST)
DRAWING NAME: M:\50162593\QUINCY DOWNTOWN REVITALIZATION\SURVEY DWG\50162593-TSDWG SC(1) BY: AFURR

A
B
C
D
E



SURVEYOR'S NOTES:

- THIS SURVEY IS REFERENCED TO FLORIDA STATE PLANE COORDINATES, NORTH ZONE, NAD 1983/2011, U.S. SURVEY FEET.
- VERTICAL DATUM SHOWN HEREON IS REFERENCED TO NORTH AMERICAN VERTICAL DATUM OF 1988 (NAVD88).
- THIS SURVEY, MAP, AND REPORT IS NOT VALID WITHOUT THE SIGNATURE AND ORIGINAL SEAL OF A FLORIDA LICENSED SURVEYOR AND MAPPER. ADDITIONS OR DELETIONS TO SURVEY MAPS OR REPORTS BY OTHER THAN THE SIGNING PARTY OR PARTIES IS PROHIBITED WITHOUT WRITTEN CONSENT OF THE SIGNING PARTY OR PARTIES.
- SOURCE OF INFORMATION: SUBDIVISION PLAT OF ORIGINAL TOWN OF QUINCY (P.B. 1, PAGE 2), AND DEEDS AS RECORDED IN THE PUBLIC RECORDS OF GADSDEN COUNTY, FLORIDA; FLORIDA DEPARTMENT OF TRANSPORTATION RIGHT-OF-WAY MAP FOR STATE ROAD NO. 10 (JEFFERSON STREET), SECTION NO. 5001-116 & 5003-104, DATED 10-11-56.
- NO TITLE SEARCH, TITLE OPINION OR ABSTRACT WAS PERFORMED BY, NOR PROVIDED TO DEWBERRY ENGINEERS INC. FOR THE SUBJECT PROPERTY. THERE MAY BE DEEDS OF RECORD, UNRECORDED DEEDS, EASEMENTS, ENCROACHMENTS, RIGHT-OF-WAYS, BUILDING SETBACKS, RESTRICTIVE COVENANTS OR OTHER INSTRUMENTS WHICH COULD AFFECT THE BOUNDARIES OR USE OF THE SUBJECT PROPERTY.
- DEWBERRY ENGINEERS INC. CALLED IN A DESIGN TICKET TO SUNSHINE 811 PRIOR TO FIELD SURVEY. UNDERGROUND UTILITIES, UTILITY LINES, FOUNDATIONS, OR OTHER UNDERGROUND STRUCTURES THAT WERE MARKED IN THE FIELD AT THE TIME OF SURVEY ARE SHOWN HEREON; HOWEVER, NO EXCAVATION OR VERIFICATION HAS BEEN PREFORMED BY DEWBERRY.
- THERE MAY BE ADDITIONAL RESTRICTIONS NOT SHOWN ON THIS SURVEY THAT MAY BE FOUND IN THE PUBLIC RECORDS OF GADSDEN COUNTY, FLORIDA.
- DATE OF FIELD SURVEY: AUGUST 07, 2023

SOURCE CONTROL POINTS:

DESCRIPTION	NORTHING	EASTING	ELEV. (NAVD 1988)
S1 FOUND N.G.S. MONUMENT "S 154"	N/A	N/A	243.22'
S2 FOUND N.G.S. MONUMENT "T 154"	N/A	N/A	246.37'

TEMPORARY SITE CONTROL POINTS:

DESCRIPTION	NORTHING	EASTING	ELEV. (NAVD 1988)
T1 SET 5/8" CAPPED IRON ROD L.B. 8011	578309.65'	1943931.49'	234.50'
T2 SET 5/8" CAPPED IRON ROD L.B. 8011	578349.71'	1944220.81'	236.76'
T3 SET 5/8" CAPPED IRON ROD L.B. 8011	578008.12'	1943887.57'	237.64'
T4 SET 5/8" CAPPED IRON ROD L.B. 8011	577914.04'	1944339.03'	241.45'
T5 SET 5/8" CAPPED IRON ROD L.B. 8011	577911.03'	1944608.09'	243.48'
T6 SET 5/8" CAPPED IRON ROD L.B. 8011	577943.13'	1945048.60'	237.08'
T7 SET NAIL AND DISK L.B. 8011	577549.94'	1943962.15'	233.92'
T8 SET NAIL AND DISK L.B. 8011	577459.26'	1944242.73'	239.79'
T9 SET 5/8" CAPPED IRON ROD L.B. 8011	577634.68'	1944569.79'	243.50'
T10 SET 5/8" CAPPED IRON ROD L.B. 8011	577450.10'	1945042.06'	239.94'



INDEX OF SHEETS:
1 OVERALL SITE CONTROL POINTS, SURVEYOR'S NOTES, AND LEGEND.
2-4 SITE BOUNDARY AND TOPOGRAPHIC SURVEY DETAILS.

SYMBOLS & ABBREVIATIONS:

- L.B. = LICENSED BUSINESS
- P.S.M. = PROFESSIONAL SURVEYOR AND MAPPER
- INW. = INVERT
- PVC = POLYVINYL CHLORIDE
- A/C = AIR CONDITIONER
- AMP POLE = AMP POLE
- TRAFFIC SIGN = TRAFFIC SIGN
- BILLBOARD SIGN = BILLBOARD SIGN
- FILL BOX = FILL BOX
- MAILBOX = MAILBOX
- WATER VALVE = WATER VALVE
- WATER METER = WATER METER
- SEWAGE MANHOLE = SANITARY SEWER MANHOLE
- STORMWATER MANHOLE = STORMWATER MANHOLE
- TELEPHONE MANHOLE = TELEPHONE MANHOLE
- IRRIGATION CONTROL VALVE = IRRIGATION CONTROL VALVE
- CLAS VALVE = CLAS VALVE
- CLEANOUT = CLEANOUT
- MONITORING WELL = MONITORING WELL
- CONCRETE BOLLARD = CONCRETE BOLLARD
- GRIP ANCHOR = GRIP ANCHOR
- UTILITY POLE = UTILITY POLE
- FLAG POLE = FLAG POLE
- BURIED FIBER OPTIC CABLE MARKER = BURIED FIBER OPTIC CABLE MARKER
- TELEPHONE BOX = TELEPHONE BOX
- TELEVISION BOX = TELEVISION BOX
- SPOT ELEVATION AT "X" = SPOT ELEVATION AT "X"
- CONTOUR ELEVATION AT 1' INTERVALS = CONTOUR ELEVATION AT 1' INTERVALS
- EXISTING OAK TREE (DIAMETER SHOWN IN INCHES) = EXISTING OAK TREE (DIAMETER SHOWN IN INCHES)
- EXISTING MAGNOLIA TREE (DIAMETER SHOWN IN INCHES) = EXISTING MAGNOLIA TREE (DIAMETER SHOWN IN INCHES)
- EXISTING HOLLEY TREE (DIAMETER SHOWN IN INCHES) = EXISTING HOLLEY TREE (DIAMETER SHOWN IN INCHES)
- BURIED FIBER OPTIC CABLE LINE = BURIED FIBER OPTIC CABLE LINE
- BURIED GAS LINE = BURIED GAS LINE
- BURIED WATER MAIN = BURIED WATER MAIN
- OVERHEAD UTILITY LINE = OVERHEAD UTILITY LINE
- EXISTING ASPHALT PAVEMENT = EXISTING ASPHALT PAVEMENT
- EXISTING CONCRETE = EXISTING CONCRETE
- EXISTING WOOD DECK = EXISTING WOOD DECK
- EXISTING BRICK PAVERS = EXISTING BRICK PAVERS
- EXISTING GRAVEL = EXISTING GRAVEL

NO.	REVISIONS	BY	DATE

TOPOGRAPHIC SURVEY CITY OF QUINCY DOWNTOWN REVITALIZATION SECTION 7, TOWNSHIP 2 NORTH, RANGE 3 WEST CITY OF QUINCY GADSDEN COUNTY, FLORIDA	DAVID JON BARTLETT, P.S.M. PROFESSIONAL SURVEYOR & MAPPER NO. 15408
FIELD BOOK/PAGE: 336/8-27 FIELD DATE: 08/07/2023 DRAWN BY: RD/AF DRAWING DATE: 08/07/2023 SHEET SCALE: 1" = 60' APPROVED BY: D.J.B.	DEWBERRY ENGINEERS INC. 203 ABERDEEN PARKWAY P.O. BOX 100 PHONE: 850.522.0644 FAX: 850.522.1011 WWW.DEWBERRY.COM CERTIFICATE OF AUTHORIZATION NO. L.B. 8011
PROJECT NO. 50162593 SHEET NO. 1 OF 4	S1

August 7, 2023 (15:18:33 EST)
DRAWING NAME: M:\50162593_QUINCY DOWNTOWN REVITALIZATION\SURVEY DWG\50162593-TSDWG S(2) BY: AFURR

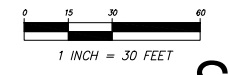
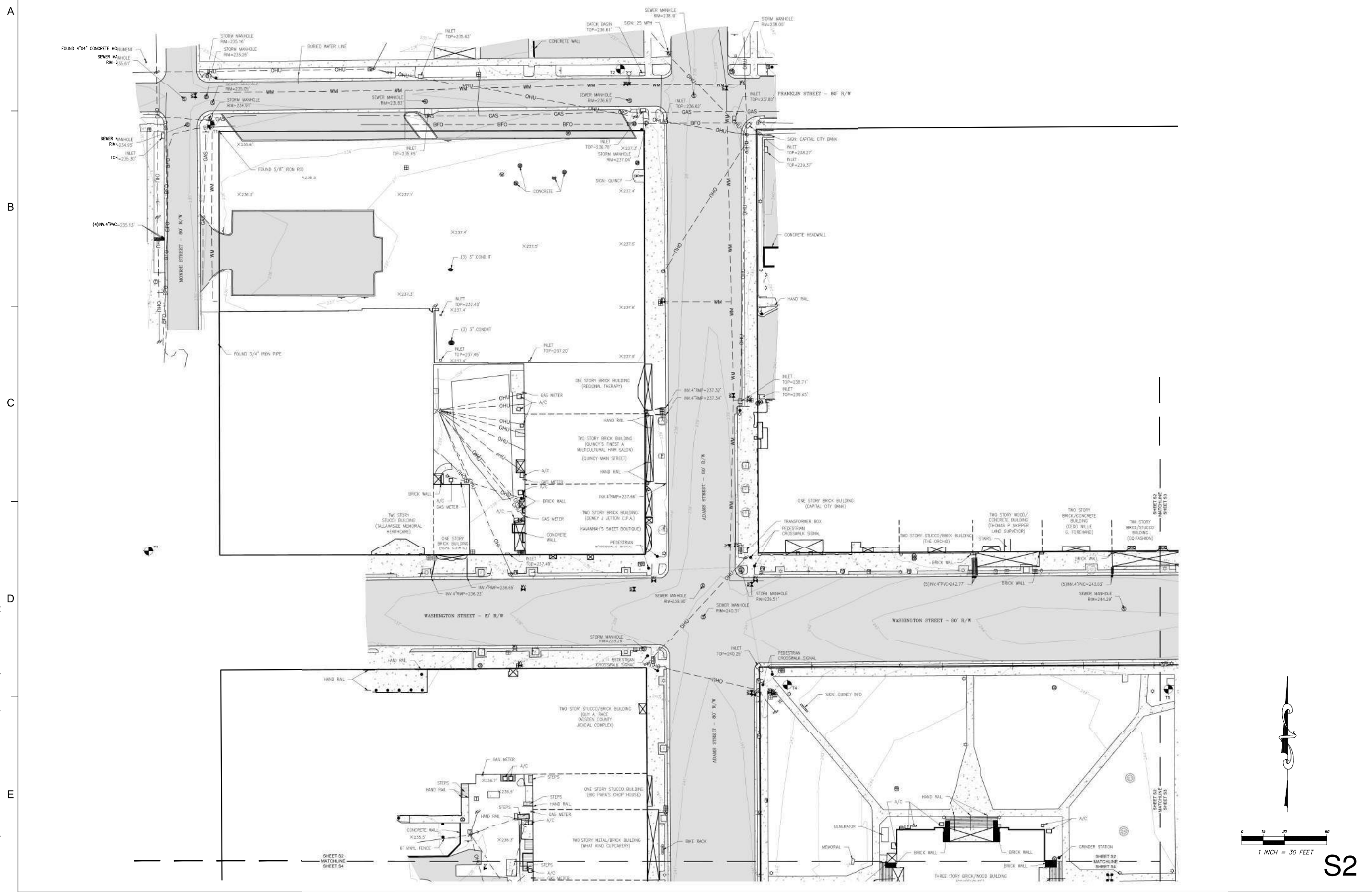

S2

REVISIONS		NO.	BY	DATE

TOPOGRAPHIC SURVEY CITY OF QUINCY DOWNTOWN REVITALIZATION SECTION 7, TOWNSHIP 2 NORTH, RANGE 3 WEST CITY OF QUINCY GADSDEN COUNTY, FLORIDA	
FIELD BOOK/PAGE: 336/8-27 FIELD DATE: 08/07/2023 DRAWN BY: RDIAF DRAWING DATE: 08/07/2023 SHEET SCALE: 1" = 30' APPROVED BY: DJB	DAVID JON BARTLETT, P.S.M. PROFESSIONAL SURVEYOR & MAPPER NO. 15408 DATE SIGNED:
PROJECT NO. 50162593 SHEET NO. 2 OF 4	DEWBERRY ENGINEERS INC. 203 ABERDEEN PARKWAY PALM BEACH, FL 33410 PHONE: 561.522.0844 FAX: 561.522.1011 WWW.DEWBERRY.COM CERTIFICATE OF AUTHORIZATION NO. L.B. 8011

August 7, 2023 (15:18:33 EST)
 DRAWING NAME: M:\50162593\QUINCY DOWNTOWN REVITALIZATION\SURVEY DWG\50162593-TSDWG S(4) BY: AFURR

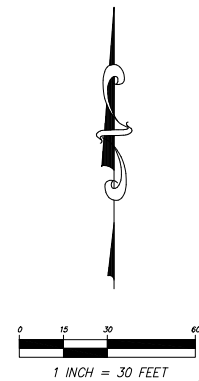
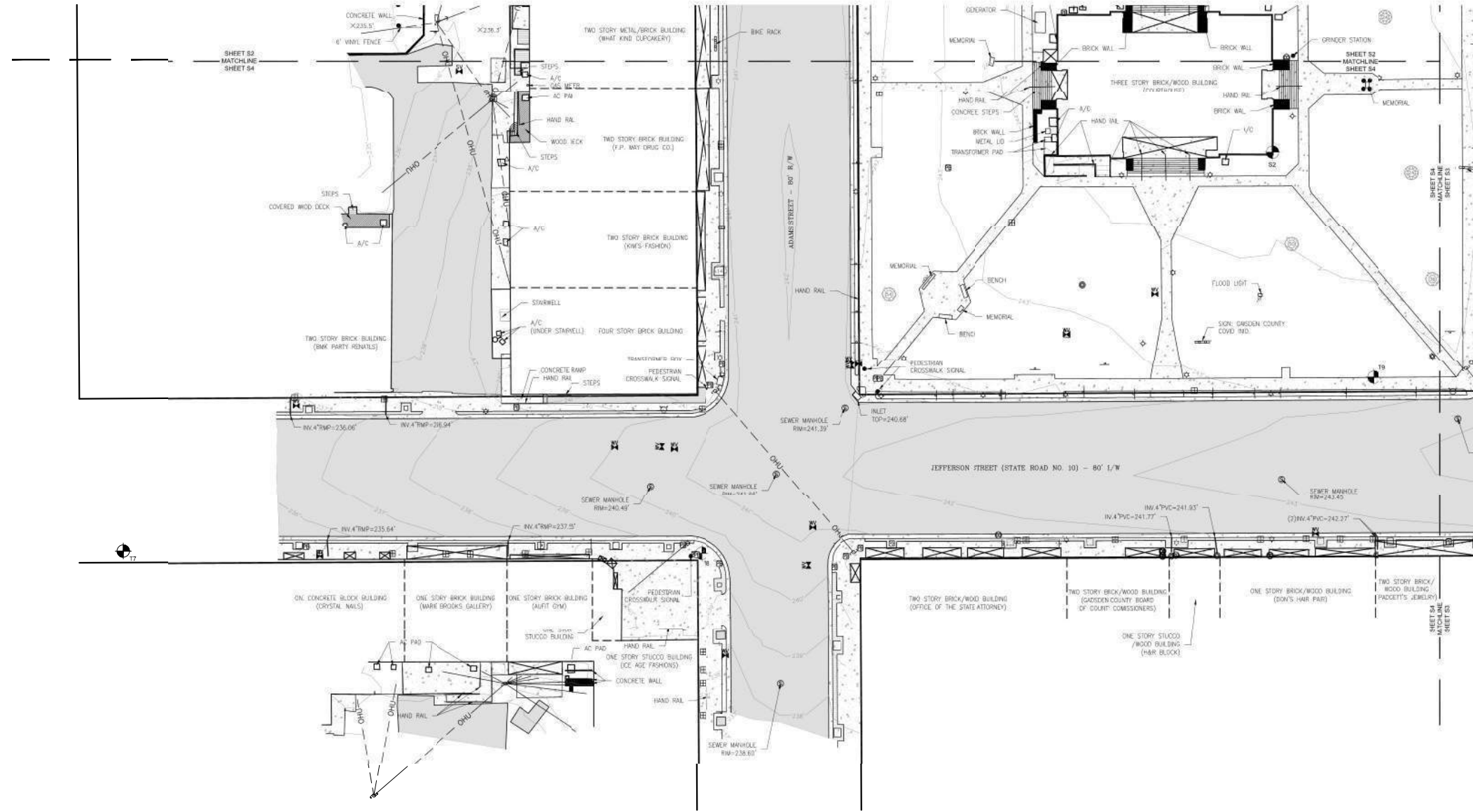

NO.		REVISIONS	
NO.	DATE	BY	DATE

TOPOGRAPHIC SURVEY
 CITY OF QUINCY DOWNTOWN REVITALIZATION
 SECTION 7, TOWNSHIP 2 NORTH, RANGE 3 WEST
 CITY OF QUINCY
 GADSDEN COUNTY, FLORIDA

FIELD BOOK/PAGE: 336/8-27
 FIELD DATE: 08/07/2023
 DRAWN BY: RDJAF
 DRAWING DATE: 08/07/2023
 SHEET SCALE: 1" = 30'
 APPROVED BY: DJB

Dewberry
 DEWBERRY ENGINEERS INC.
 203 ABERDEEN PARKWAY
 GADSDEN COUNTY, FLORIDA 32040
 PHONE: 850.522.0844 FAX: 850.522.1011
 WWW.DEWBERRY.COM
 CERTIFICATE OF AUTHORIZATION
 NO. L.B. 8011

PROJECT NO. 50162593
 SHEET NO. 4 OF 4

S4

QUINCY FLORIDA
CDBG HR IMPROVEMENTS

QUINCY FLORIDA

SEAL

DAVID P. REISEN P.E. #60229
EB 0008794

BID SET

SCALE

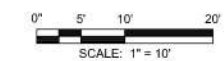

REVISIONS

NO.	DESCRIPTION	DATE

DRAWN BY: DPR
APPROVED BY: _____
CHECKED BY: DPR
DATE: APRIL 2026

TITLE

**ANDY GAY PARK
SITE PLAN**

PROJECT NO. 50162593

C1

SHEET NO.

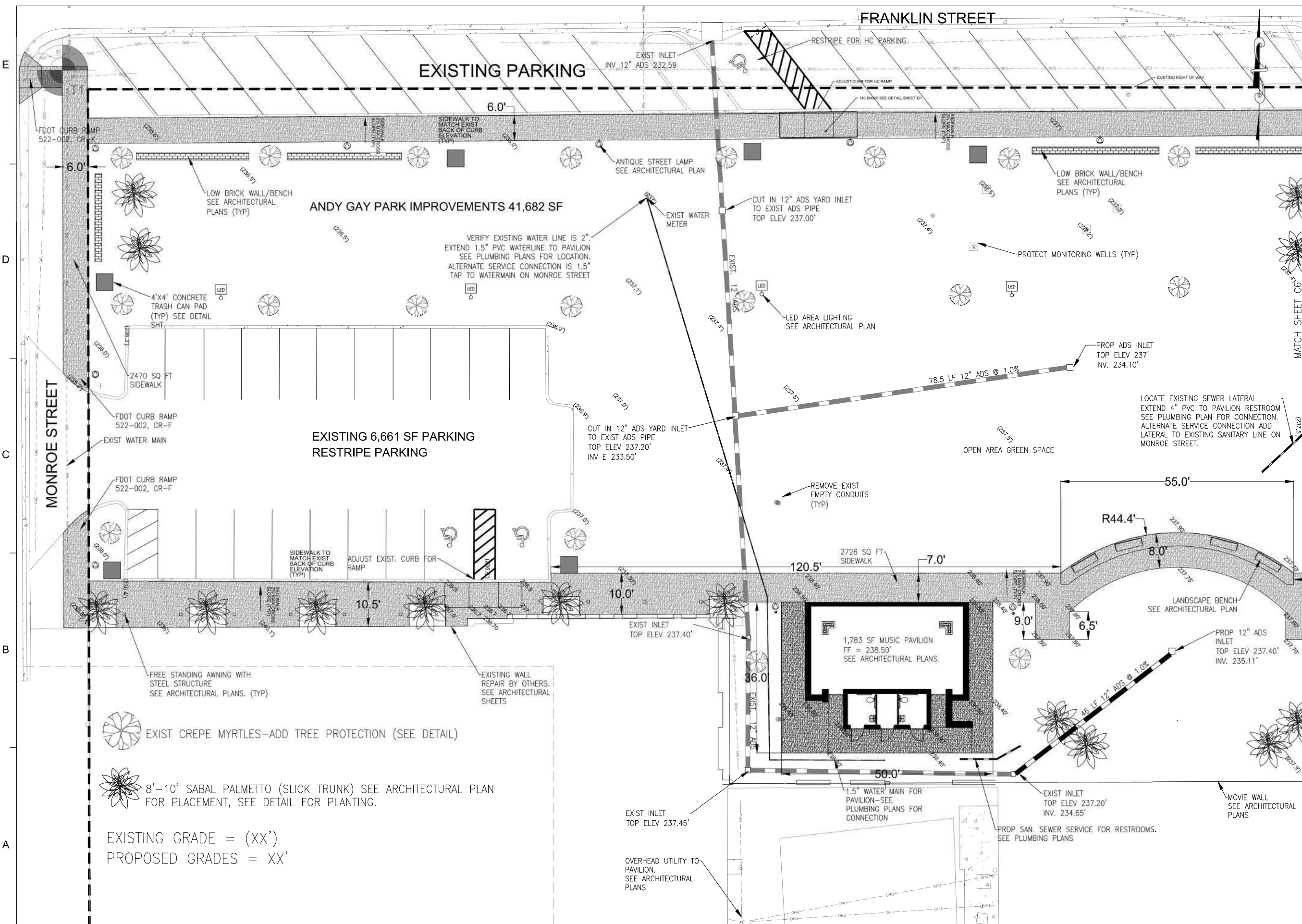

Z:\PROJECTS\QUINCY\16162593_CDBG-HR_ENGINEERING\PRODUCTION\QUINCY_CDBG-HR_REDUCED_SCOPE_2.2026.DWG

**CDBG HR IMPROVEMENTS
QUINCY FLORIDA**

Z:\PROJECTS\QUINCY\6162593_CDBG-HR_ENGINEERING\PRODUCTION\QUINCY_CDBG REDUCED SCOPE 2.2026.DWG

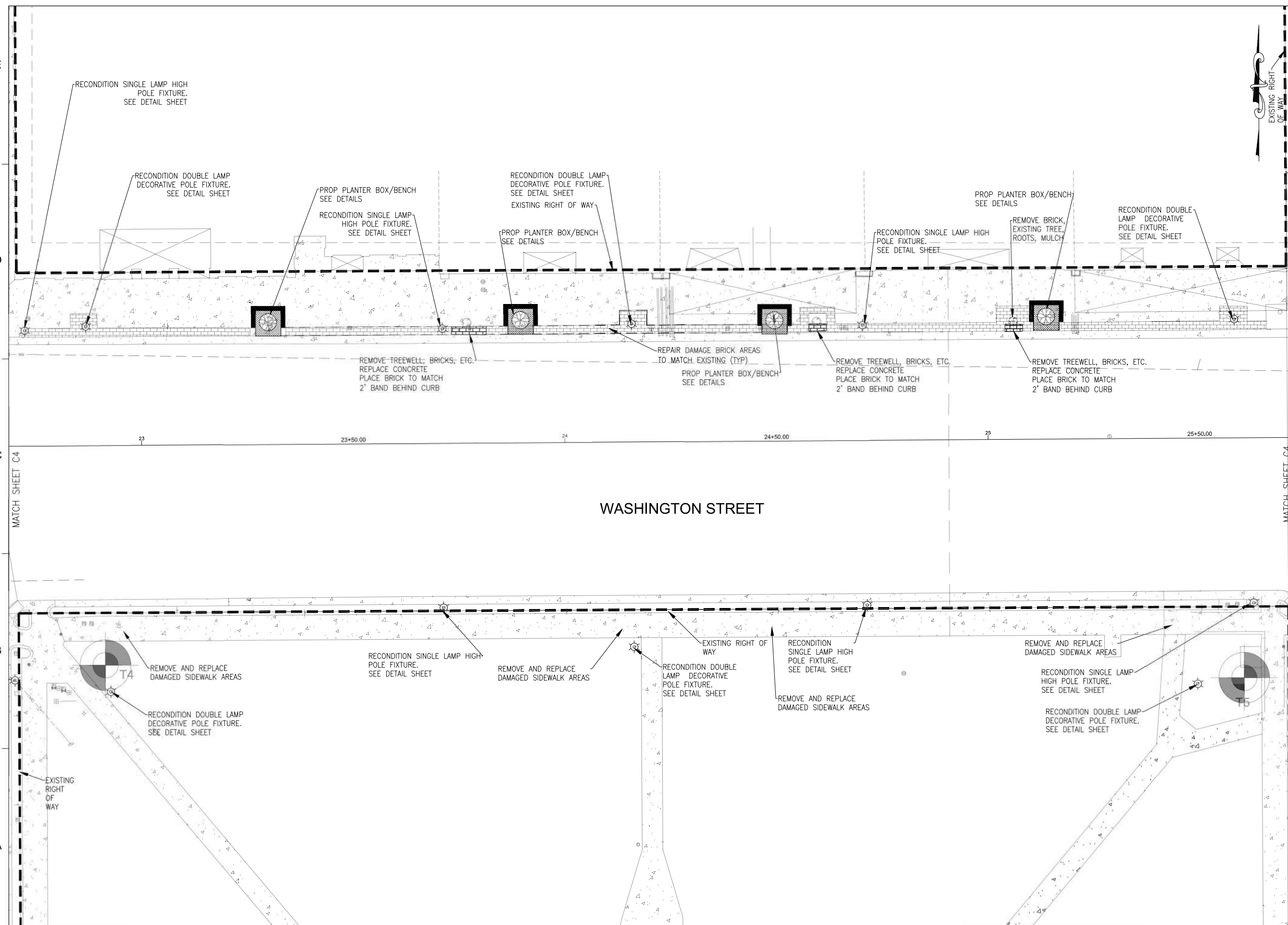

SEAL

DAVID P. REISEN P.E. #60229
EB 0008794

BID SET

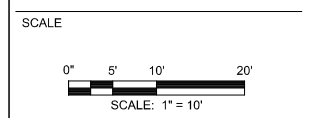

REVISIONS

NO.	DESCRIPTION	DATE

DRAWN BY: DPR
APPROVED BY: _____
CHECKED BY: DPR
DATE: APRIL 2026

TITLE

**WASHINGTON STREET
PLAN VIEW**

PROJECT NO. 50162593

C2

SHEET NO.

**CDBG HR IMPROVEMENTS
QUINCY FLORIDA**

SEAL

DAVID P. REISEN P.E. #60229
EB 0008794

BID SET

SCALE

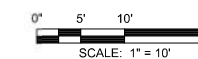

REVISIONS

NO.	DESCRIPTION	DATE

DRAWN BY DPR
 APPROVED BY
 CHECKED BY DPR
 DATE APRIL 2026

TITLE

**WASHINGTON STREET
PLAN VIEW**

PROJECT NO. 50158855

C3

SHEET NO.

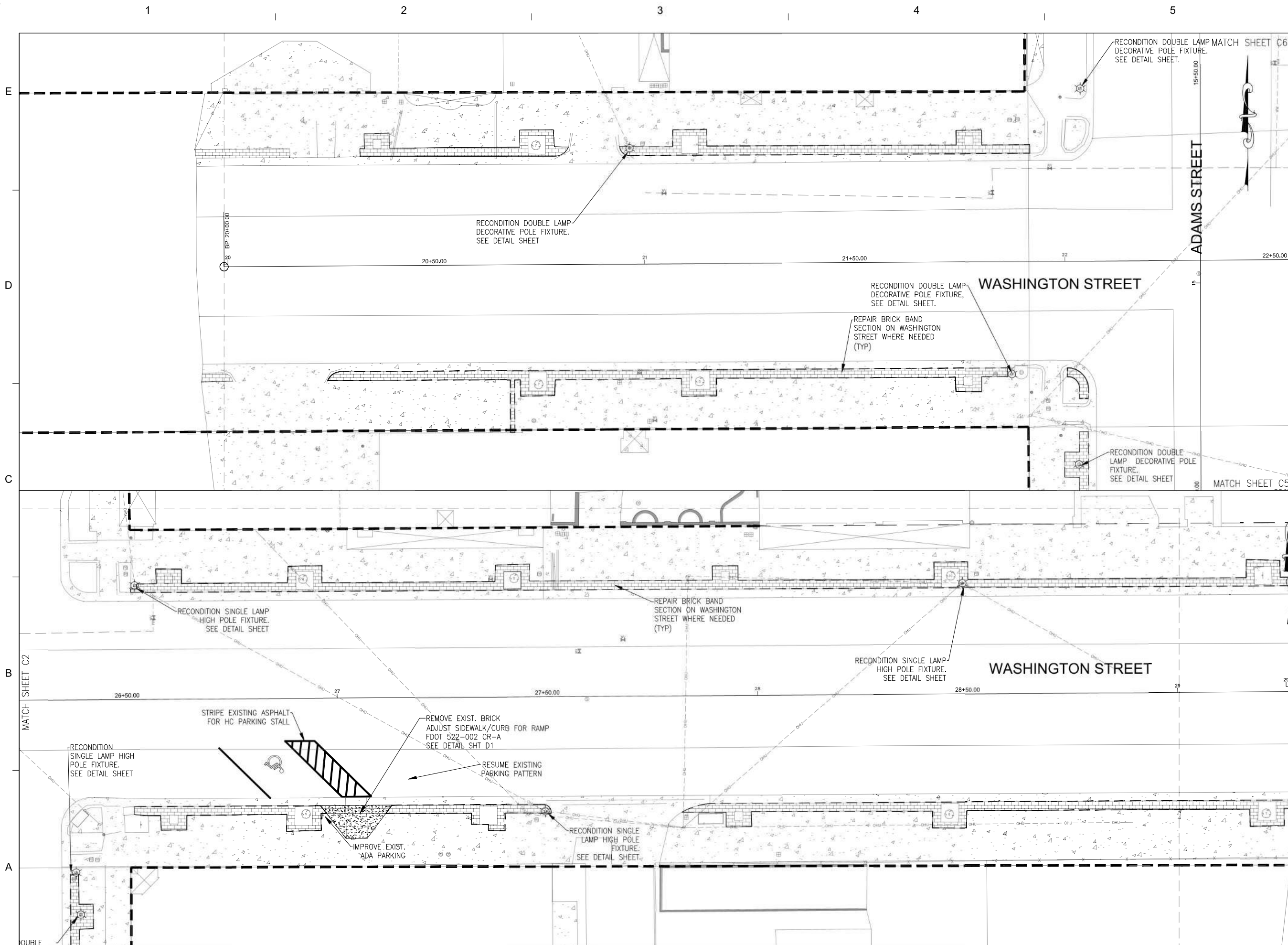

Z:\PROJECTS\QUINCY\16162893_CDBG-HR_ENGINEERING\PRODUCTION\QUINCY_CDBG_REDUCED_SCOPE_2.2026.DWG

**CDBG HR IMPROVEMENTS
QUINCY FLORIDA**

Z:\PROJECTS\QUINCY\QUINCY\ENGINEERING\PRODUCTION\QUINCY_CDBG-HR_REDUCED_SCOPE_2.2026.DWG

SEAL

DAVID P. REISEN P.E. #60229
EB 0008794

BID SET

SCALE

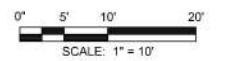

REVISIONS

NO.	DESCRIPTION	DATE

DRAWN BY DPR
 APPROVED BY
 CHECKED BY DPR
 DATE APRIL 2026

TITLE
**ADAMS STREET
 PLAN VIEW**

PROJECT NO. 50158855

C4

SHEET NO.

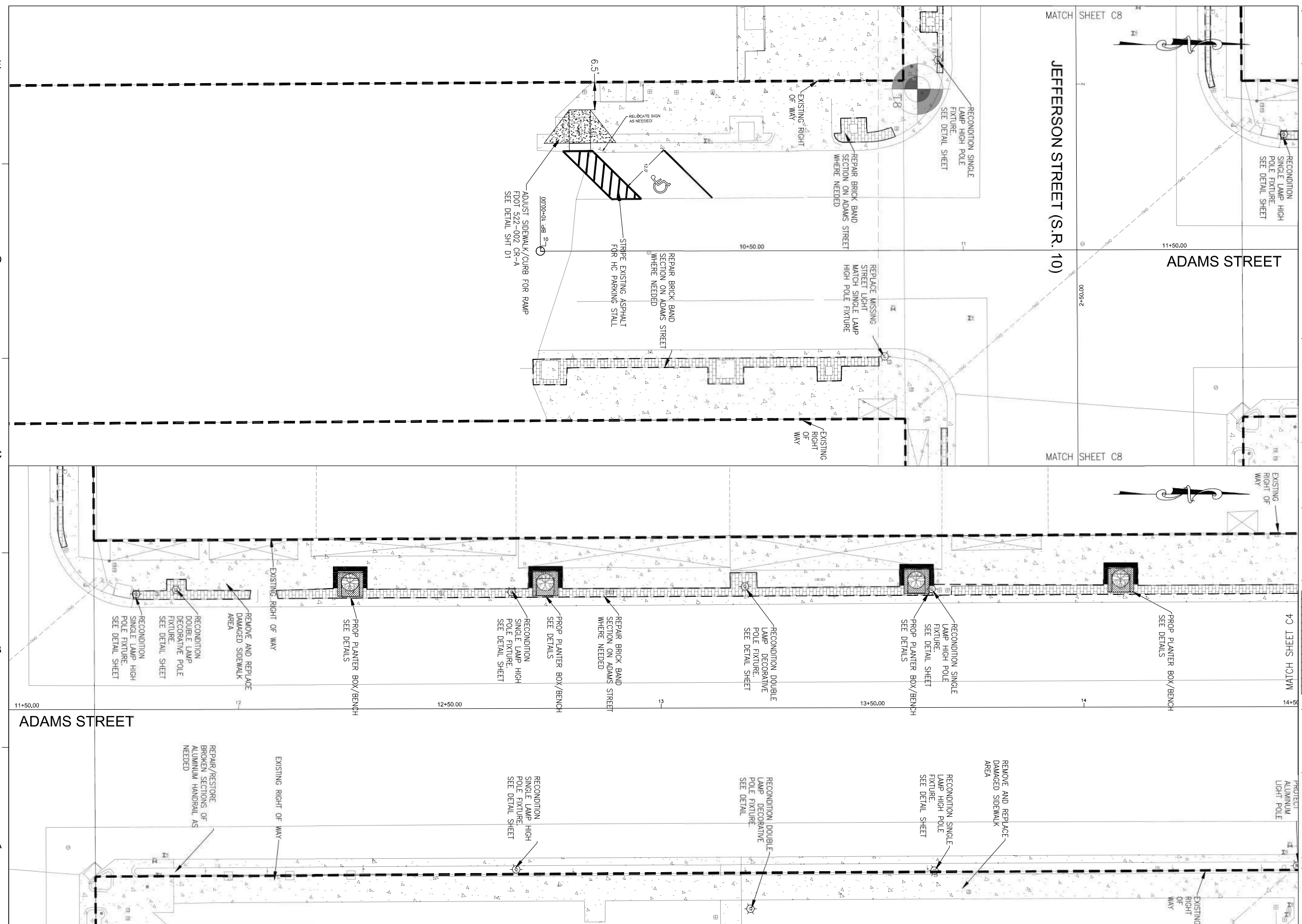

E
D
C
B
A

1

2

3

4

5

MATCH SHEET C8

JEFFERSON STREET (S.R. 10)

ADAMS STREET

MATCH SHEET C8

MATCH SHEET C4

ADAMS STREET

PROJECT ALUMINUM LIGHT POLE

A

**CDBG HR IMPROVEMENTS
QUINCY FLORIDA**

Z:\PROJECTS\QUINCY\HR\ENGINEERING\PRODUCTION\QUINCY_CDBG_HR_REDUCED_SCOPE_2.2026.DWG

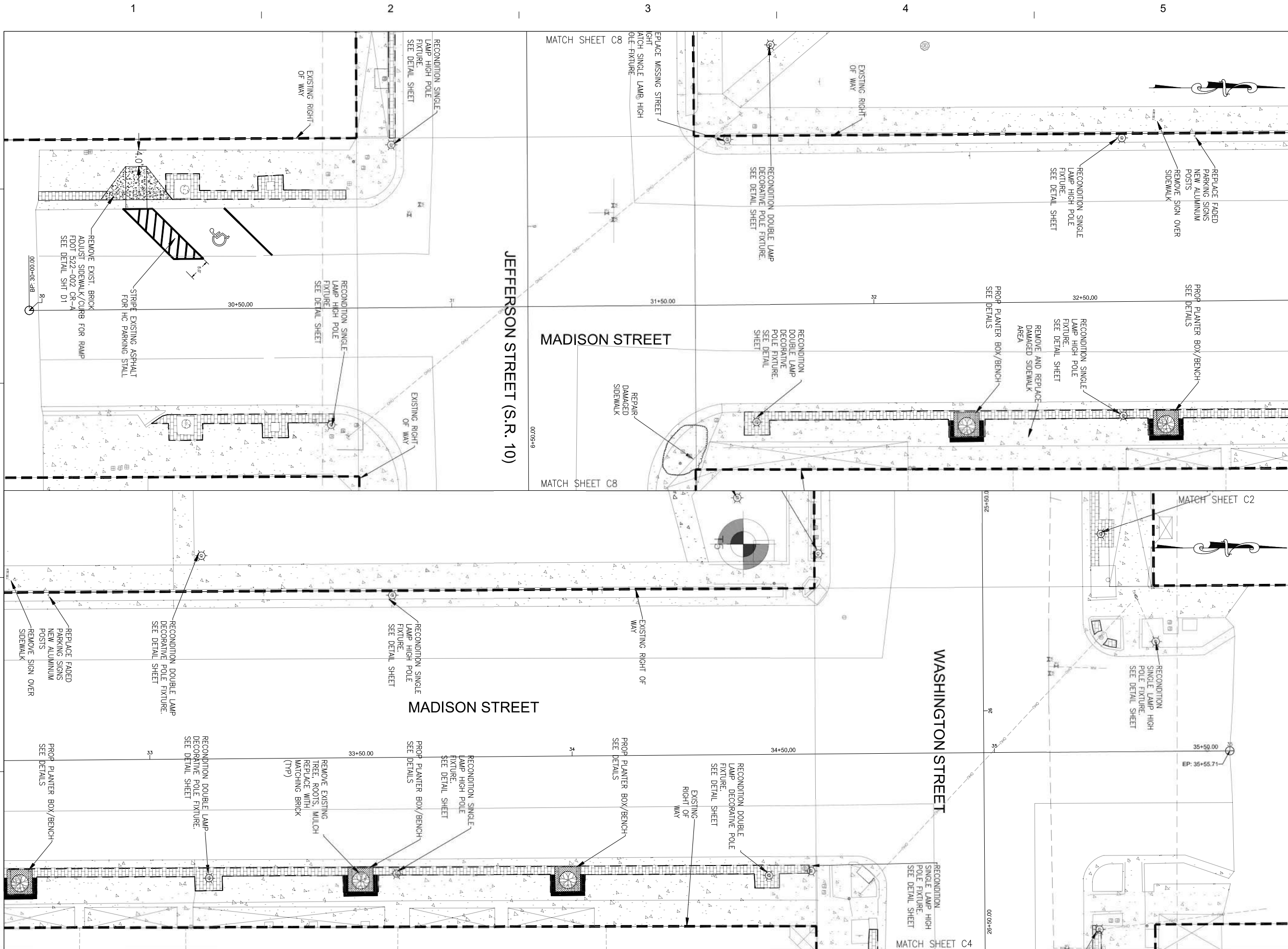

SEAL

DAVID P. REISEN P.E. #60229
EB 0008794

BID SET

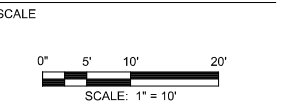

REVISIONS

NO.	DESCRIPTION	DATE

DRAWN BY: DPR
APPROVED BY: _____
CHECKED BY: DPR
DATE: APRIL 2026

TITLE
**MADISON STREET
PLAN VIEW**

PROJECT NO. 50158855

SHEET NO. **C6**

**CDBG HR IMPROVEMENTS
QUINCY FLORIDA**

SEAL

DAVID P. REISEN P.E. #60229
EB 0008794

BID SET

SCALE

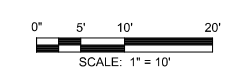

REVISIONS

NO.	DESCRIPTION	DATE

DRAWN BY: DPR
APPROVED BY: _____
CHECKED BY: DPR
DATE: APRIL 2026

TITLE
**JEFFERSON STREET
PLAN VIEW**

PROJECT NO. 50158855

C7

SHEET NO.

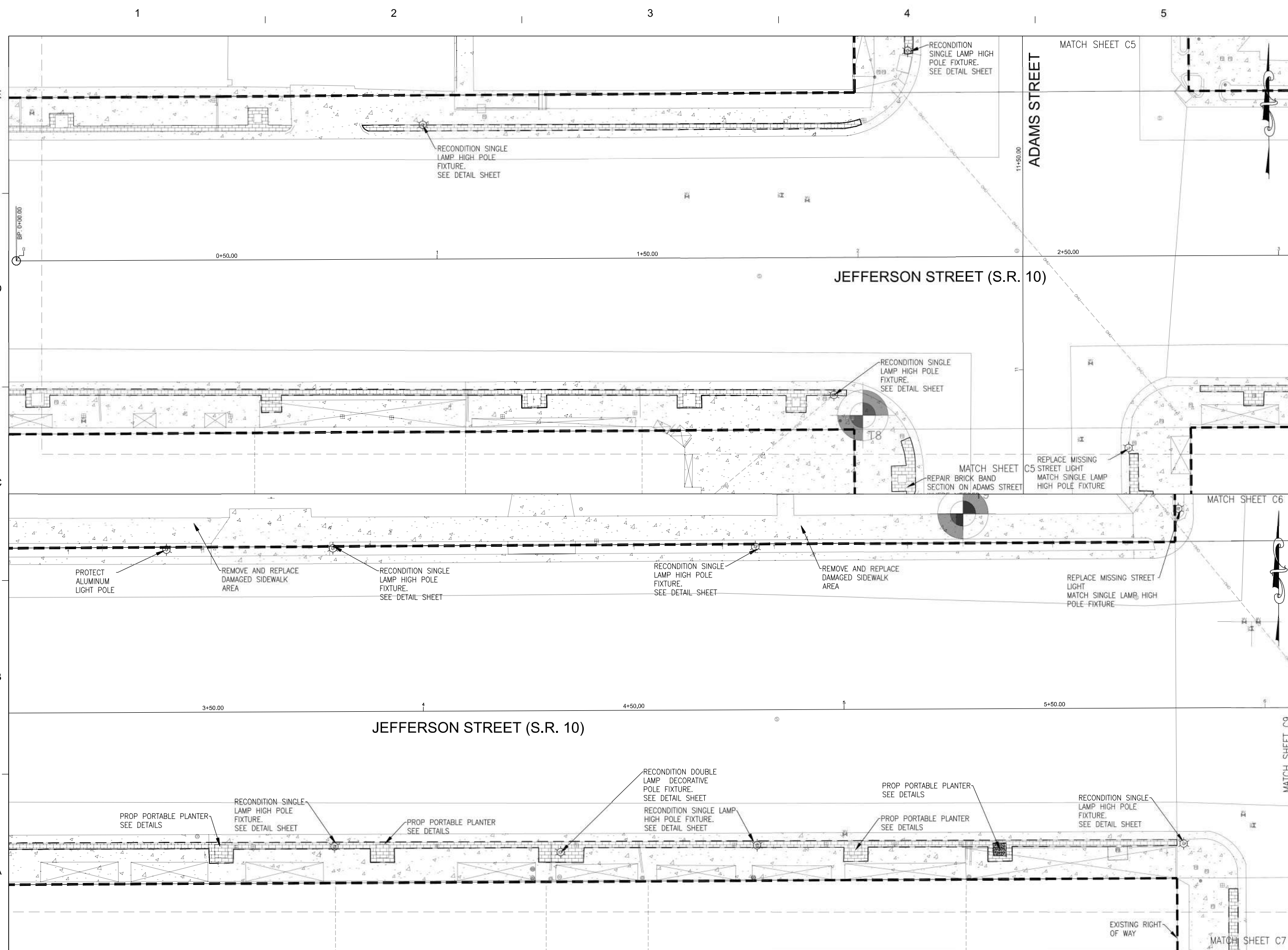

Z:\PROJECTS\QUINCY\ENGINEERING\PRODUCTION\QUINCY_CDBG_HR_REDUCED_SCOPE_2.2026.DWG

**CDBG HR IMPROVEMENTS
QUINCY FLORIDA**

Z:\PROJECTS_QUINCY\16162893_CDBG-HR_ENGINEERING\PRODUCTION\QUINCY_CDBG_REDUCED_SCOPE_2.2026.DWG

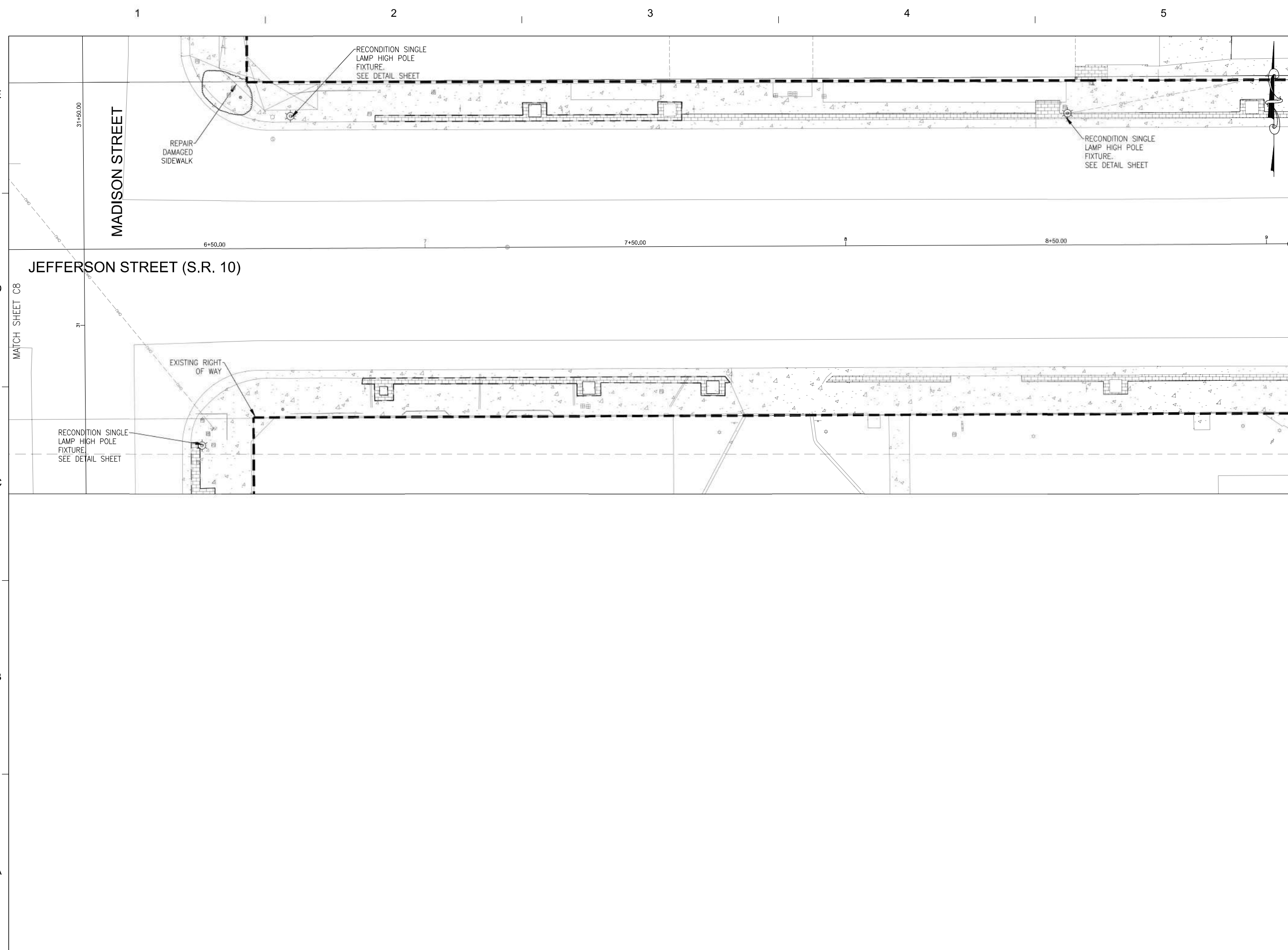

SEAL

DAVID P. REISEN P.E. #60229
EB 0008794

BID SET

SCALE

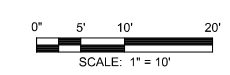

REVISIONS

NO.	DESCRIPTION	DATE

DRAWN BY DPR
 APPROVED BY
 CHECKED BY DPR
 DATE APRIL 2026

TITLE
**JEFFERSON
STREET
PLAN VIEW**

PROJECT NO. 50158855

C8

SHEET NO.

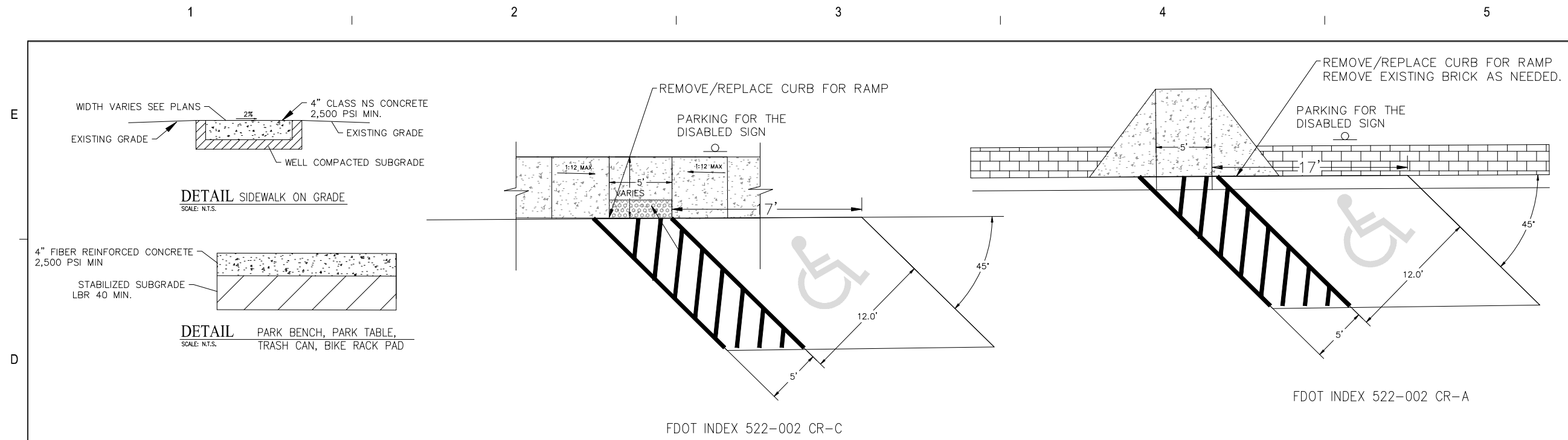

FDOT INDEX 522-002 CR-C

TYPICAL STRIPING AND PARKING DIMENSIONS

NOTE:
ALL STANDARD SPACES SHALL HAVE WHITE STRIPING.
ALL HANDICAP SPACES SHALL BE TRAFFIC PAINT STRIPING.

SEAL

DAVID P. REISEN P.E. 60229
EB 0008794

BID SET

SCALE

NO SCALE

REVISIONS

NO.	DESCRIPTION	DATE

DRAWN BY: D REISEN
APPROVED BY: _____
CHECKED BY: _____
DATE: APRIL 2026

TITLE

PROJECT DETAILS

PROJECT NO. 50162593

D1

SHEET NO.

REVISIONS

NO.	DESCRIPTION	DATE

DRAWN BY: DPR
APPROVED BY: _____
CHECKED BY: DPR
DATE: APRIL 2026

TITLE
PROJECT DETAILS

PROJECT NO. 50158855

D5

SHEET NO.

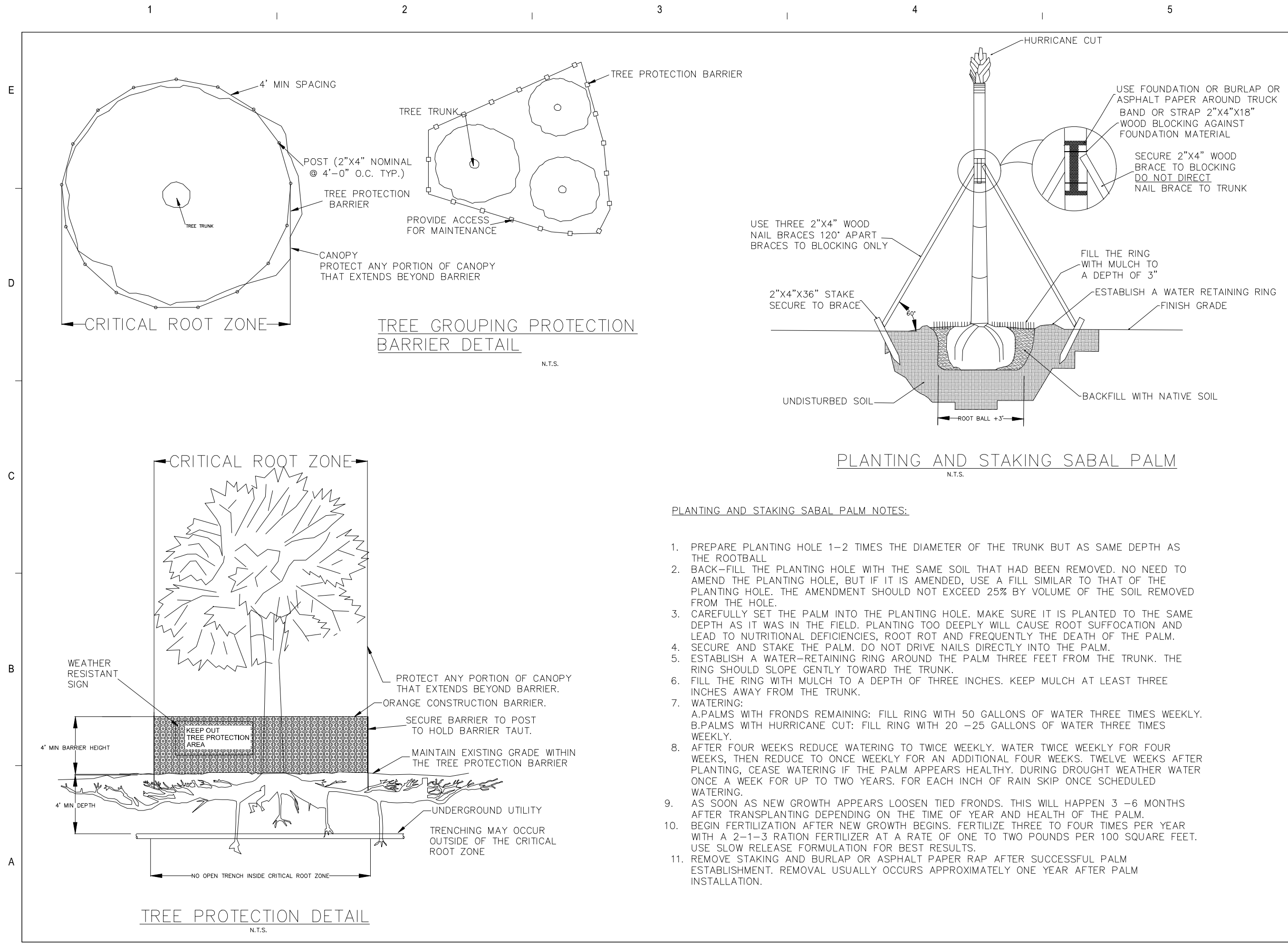

PLANTING AND STAKING SABAL PALM NOTES:

1. PREPARE PLANTING HOLE 1-2 TIMES THE DIAMETER OF THE TRUNK BUT AS SAME DEPTH AS THE ROOTBALL
2. BACK-FILL THE PLANTING HOLE WITH THE SAME SOIL THAT HAD BEEN REMOVED. NO NEED TO AMEND THE PLANTING HOLE, BUT IF IT IS AMENDED, USE A FILL SIMILAR TO THAT OF THE PLANTING HOLE. THE AMENDMENT SHOULD NOT EXCEED 25% BY VOLUME OF THE SOIL REMOVED FROM THE HOLE.
3. CAREFULLY SET THE PALM INTO THE PLANTING HOLE. MAKE SURE IT IS PLANTED TO THE SAME DEPTH AS IT WAS IN THE FIELD. PLANTING TOO DEEPLY WILL CAUSE ROOT SUFFOCATION AND LEAD TO NUTRITIONAL DEFICIENCIES, ROOT ROT AND FREQUENTLY THE DEATH OF THE PALM.
4. SECURE AND STAKE THE PALM. DO NOT DRIVE NAILS DIRECTLY INTO THE PALM.
5. ESTABLISH A WATER-RETAINING RING AROUND THE PALM THREE FEET FROM THE TRUNK. THE RING SHOULD SLOPE GENTLY TOWARD THE TRUNK.
6. FILL THE RING WITH MULCH TO A DEPTH OF THREE INCHES. KEEP MULCH AT LEAST THREE INCHES AWAY FROM THE TRUNK.
7. WATERING:
A. PALMS WITH FRONDS REMAINING: FILL RING WITH 50 GALLONS OF WATER THREE TIMES WEEKLY.
B. PALMS WITH HURRICANE CUT: FILL RING WITH 20 -25 GALLONS OF WATER THREE TIMES WEEKLY.
8. AFTER FOUR WEEKS REDUCE WATERING TO TWICE WEEKLY. WATER TWICE WEEKLY FOR FOUR WEEKS, THEN REDUCE TO ONCE WEEKLY FOR AN ADDITIONAL FOUR WEEKS. TWELVE WEEKS AFTER PLANTING, CEASE WATERING IF THE PALM APPEARS HEALTHY. DURING DROUGHT WEATHER WATER ONCE A WEEK FOR UP TO TWO YEARS. FOR EACH INCH OF RAIN SKIP ONCE SCHEDULED WATERING.
9. AS SOON AS NEW GROWTH APPEARS LOOSEN TIED FRONDS. THIS WILL HAPPEN 3 -6 MONTHS AFTER TRANSPLANTING DEPENDING ON THE TIME OF YEAR AND HEALTH OF THE PALM.
10. BEGIN FERTILIZATION AFTER NEW GROWTH BEGINS. FERTILIZE THREE TO FOUR TIMES PER YEAR WITH A 2-1-3 RATION FERTILIZER AT A RATE OF ONE TO TWO POUNDS PER 100 SQUARE FEET. USE SLOW RELEASE FORMULATION FOR BEST RESULTS.
11. REMOVE STAKING AND BURLAP OR ASPHALT PAPER RAP AFTER SUCCESSFUL PALM ESTABLISHMENT. REMOVAL USUALLY OCCURS APPROXIMATELY ONE YEAR AFTER PALM INSTALLATION.